

Reaching Out by Reaching In: *Government Information* *STACKS MAYHEM*

Shari Laster, UCSB Library – slaster@ucsb.edu
Federal Depository Library Conference
Wednesday, 19 October 2016

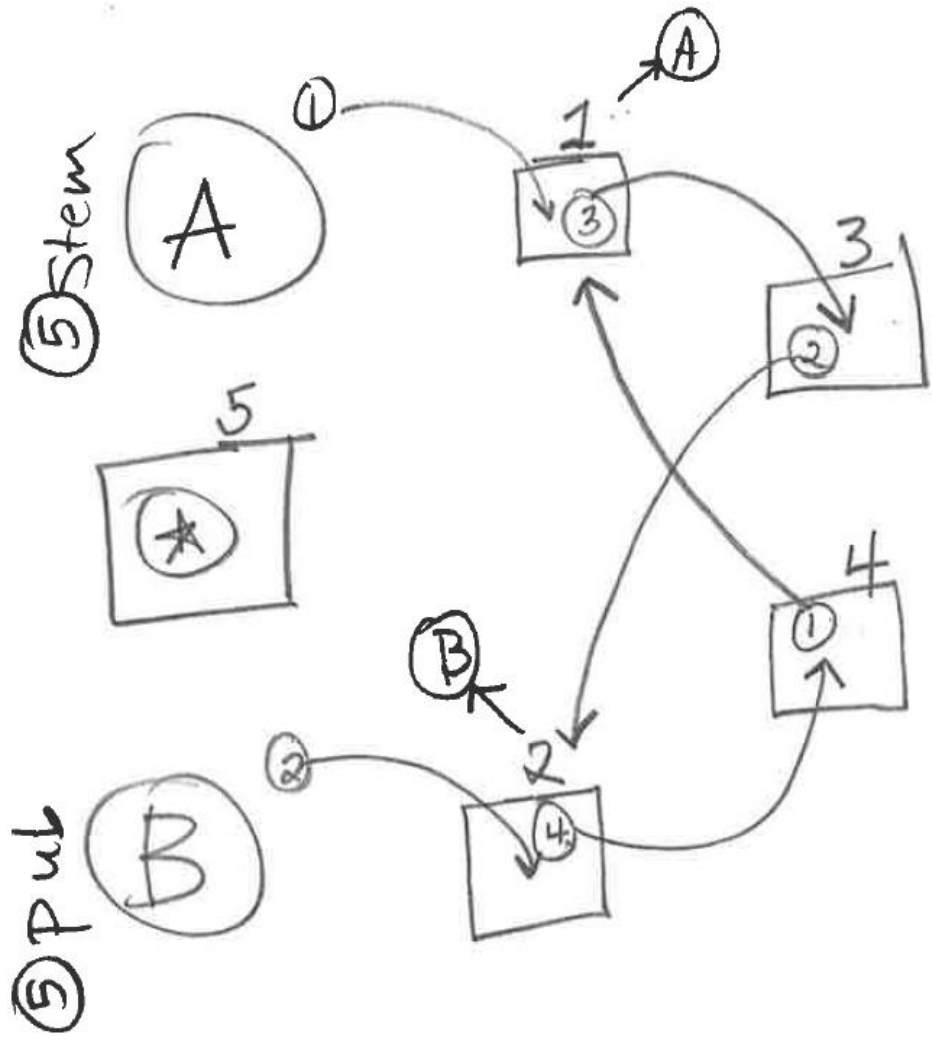



DO NOT MARK THIS END

64

DO NOT MARK THIS END

DO NOT MARK THIS END



RE INVENTING THE LIBRARY | The Crossroads of UC Santa Barbara



University Library, University of California, Santa Barbara

CLOSE X

The University of California, Santa Barbara updated and expanded its library to include a spacious, open three-story addition with large windows that flood the space with light. The first two floors serve as a 24/7 information commons with group study spaces, interactive rooms, and a café, while the third houses special collections.

Project: Renovation and expansion

Architect: Pfeiffer Partners

Size: 320,000 square feet

Cost: \$76 million

Photo: Steve Lerum

Live

american libraries **LIVE**

Live: Digitization

JobLIST

Your #1 source for jobs in Library and Information Science and Technology

EMPLOYERS
Strengthen your candidate pool—ALA reaches the most highly skilled professionals and librarians

JOB SEEKERS
Search and sort hundreds of job ads, apply for jobs, and post your resume for employers to view in the job seeker bank

ALA American Library Association
ACRL Association to Advance Collegiate Schools of Learning
libraries HRDR news

joblist.ala.org

american

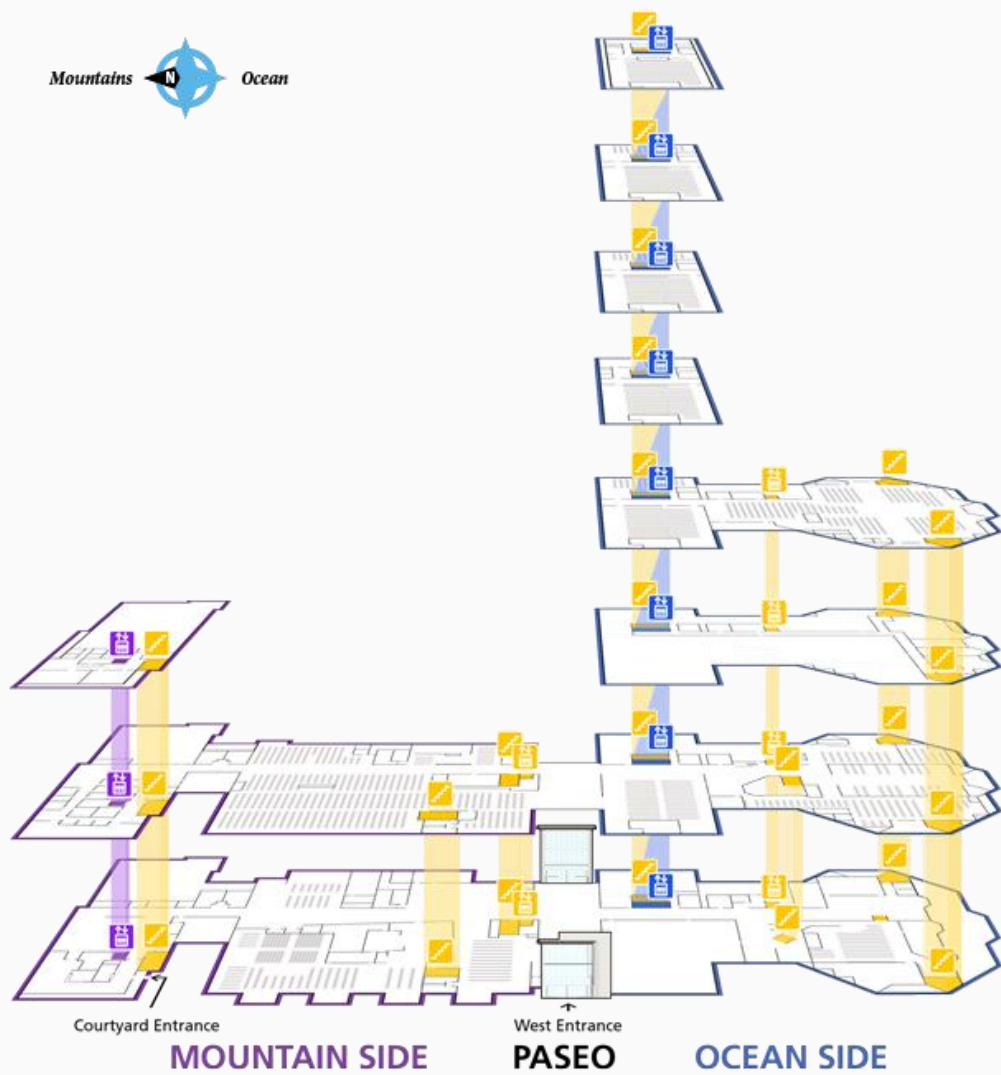

Courtyard Entrance

West Entrance

MOUNTAIN SIDE

PASEO

OCEAN SIDE

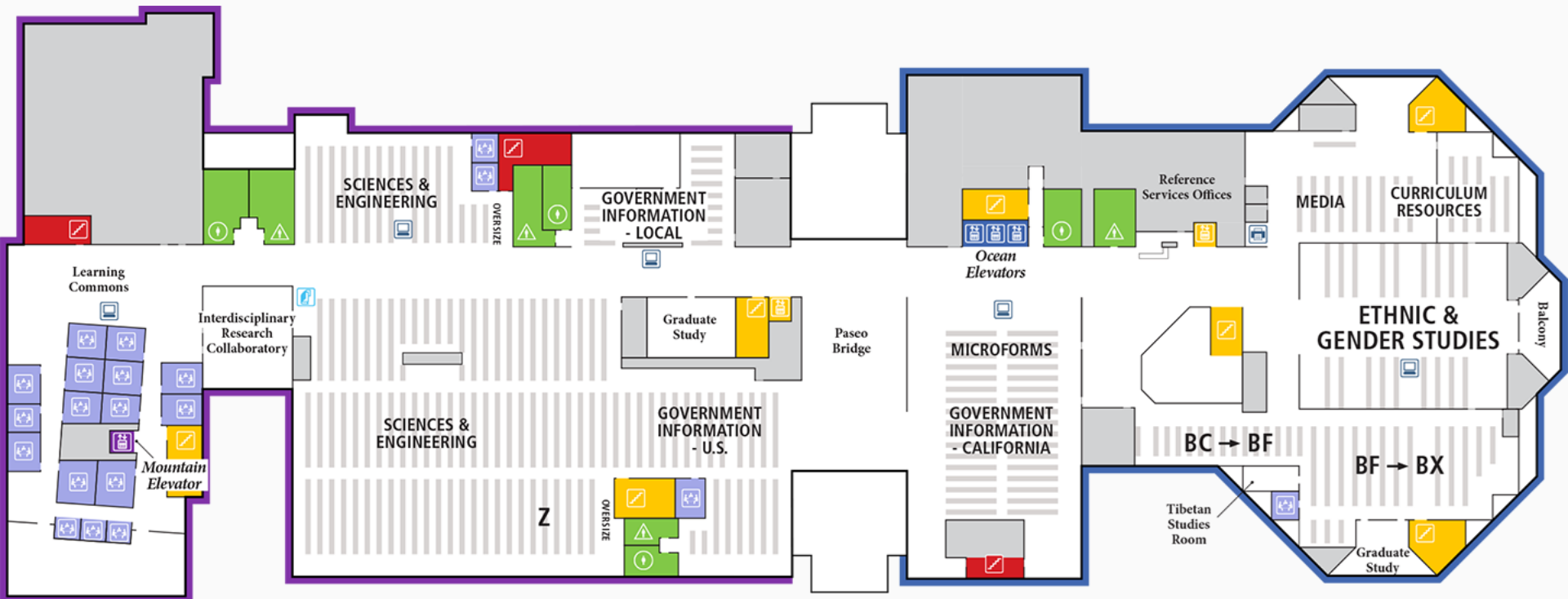



LOWER PENINSULA
An Historical and
and In

Govt Pub
US
I 29.2:N 14

I 29.2:
C 24

TALK THAT PUBLIC TALK

Govt Pub
US
I 29.2:N 14

Example of a SuDoc Sort



A 13.2:T 73/4
A 93.2:N 95/3
A 93.73:76
A 93.73:89
A 93.73/2:62
C 13.58:7564
C 13.58:7611
HE 20.4002:AD 9/2
HE 20.4002:AD9/5
HE 20.4002:F 94
L 36.202:F 15/2
L 36.202:F 15/2/980
L 36.202:F 15/3
Y 1.1/7:109-118
Y 1.1/7:109-131
Y 1.1/7:110-6
Y 1.1/7:110-20
Y 4.EC 7:C 73/7
Y 4.EC 7:C 73/10
Y 4.EC 7:S.HRG.110-646
Y 4.EC 7:SA 9/2
Y 4.EC 7:SCH 6
Y 4.EC 7:SE 2

MAYHEM

17

als



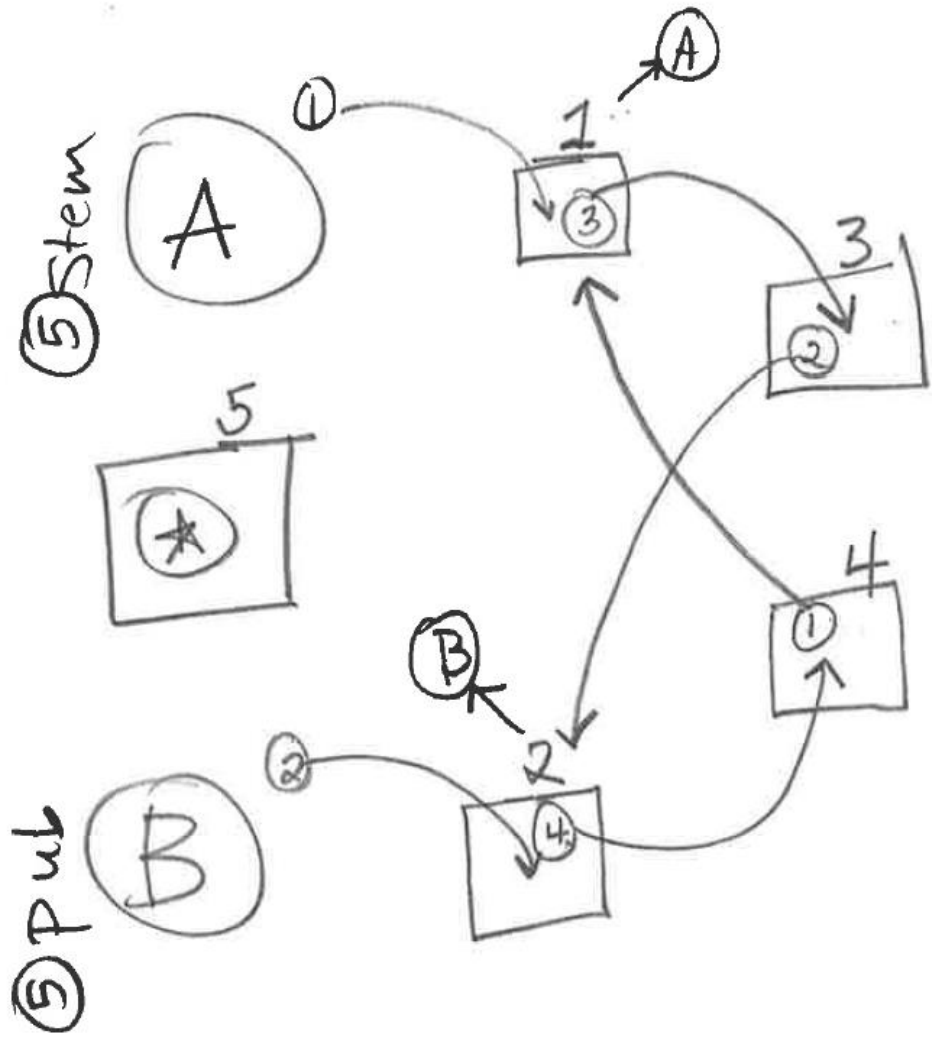

⑤ Stem

⑤ Pub

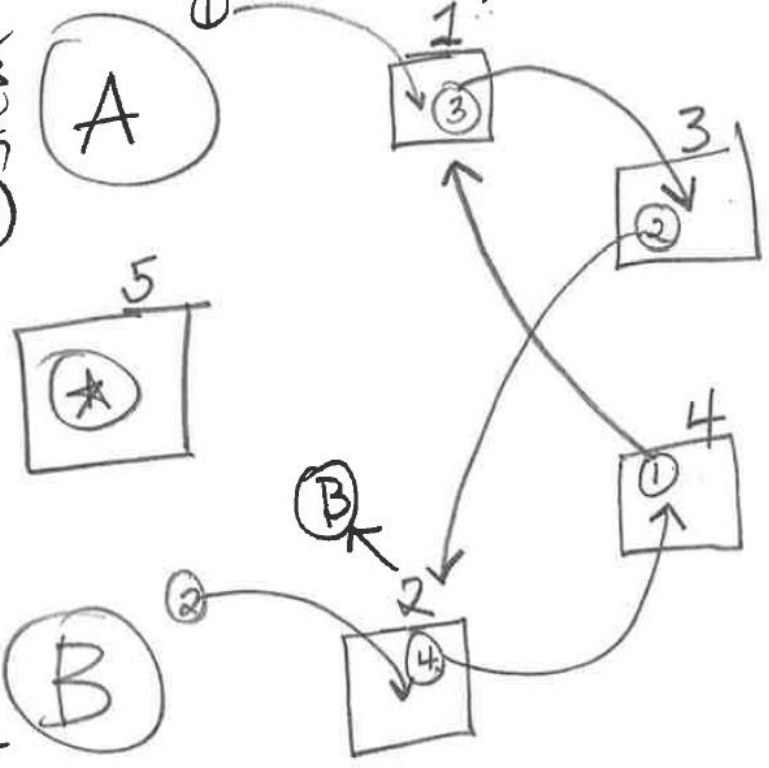

- ① for A ; ① on 4
- ② for B ; ② on 3
- ③ on 1
- ④ on 2
- ⑤ stem for A
- ⑤ pub for B
- ★ on 5

	A	B	C	D	E
1655	1407136	A 1.68:1311	31205014943540	Engineering in a forestry environment.	1982
1656	1405089	A 1.68:1312	31205014944951	'Appalow' sericea lespedeza.	1982
1657	1400525	A 1.68:1313	31205014944878	Bovine tuberculosis : still a threat to U.S. cattle herds.	1982
1658	1400526	A 1.68:1314	31205014945040	National Agricultural Library online training classes / prepared by United States Department of Ag	1982
1659	1409167	A 1.68:1316	31205014944969	The State agricultural experiment stations and research for agriculture : an investment to feed th	1983
1660	1460865	A 1.68:1317/988	31205014944696	The Great Plains Conservation Program.	1988
1661	1407612	A 1.68:1318	31205014944779	Atlantic coastal panicgrass.	1982
1662	1412804	A 1.68:1319	31205014944860	'Cochise' atherstone lovegrass.	1983
1663	1417910	A 1.68:1320	31205014945024	'Corto' Australian saltbush.	1983
1664	1498508	A 1.68:1321/991	31205014944944	Biological control of the alfalfa weevil.	1991
1665	1745774	A 1.68:1322	31205014943607	Patent license program.	1983
1666	1417658	A 1.68:1325	31205014943433	Geologists and mining engineers : consider a career in the Forest Service.	1983
1667	1926619	A 1.68:1328/997	31205019918935	Natural disaster assistance available from the United States Department of Agriculture / Disaster	1997
1668	2420007	A 1.68:1329/2002	31205027408911	Don't move gypsy moth.	2002
1669	1486881	A 1.68:1331/990	31205014962995	Food buying guide for child nutrition programs / [prepared by Nutrition and Technical Services Div	1984
1670	1745778	A 1.68:1332	31205014943631	Building bridges : volunteers in WIC and CSFP.	1983
1671	1425670	A 1.68:1334	31205014944225	'Indigo' silky dogwood.	1984
1672	1425672	A 1.68:1335	31205014944142	'Tropic Sun' sunn hemp.	1984
1673	1417101	A 1.68:1336	31205014946378	Services available through the U.S. Department of Agriculture.	1984
1674	1745165	A 1.68:1337/994	31205014935827	'Cardan' green ash.	1994
1675	1745166	A 1.68:1338/994	31205014935777	'Midwest' manchurian crabapple.	1994
1676	1745167	A 1.68:1339/994	31205014935850	'Oahe' hackberry.	1994
1677	2143126	A 1.68:1340/999	31205023280306	Facts about the food stamp program.	1999
1678	1974890	A 1.68:1341/997	31205021453186	Custodial account instructions.	1997
1679	1422755	A 1.68:1348	31205014944894	U.S. poultry industry : building a better bird / [prepared by Extension Service].	1984
1680	1423632	A 1.68:1349	31205014944886	What are the FACS.	1984
1681	1429305	A 1.68:1350	31205014945032	'Rountree' big bluestem and 'Rumsey' indiagrass.	1984
1682	1461641	A 1.68:1352/988	31205014944803	Assistance available from the Soil Conservation Service.	1988
1683	1437757	A 1.68:1353	31205014944720	Avian influenza : a threat to U.S. poultry.	1984
1684	1501146	A 1.68:1354/992	31205014944647	Small watershed projects.	1992
1685	1423639	A 1.68:1355	31205014945081	ASCS conservation programs.	1984
1686	1423640	A 1.68:1356	31205014944936	Extension home economists : helping people put knowledge to work.	1984
1687	1428589	A 1.68:1358	31205014944639	'Golden' chinquapin.	1984
1688	1424928	A 1.68:1359	31205014944795	Extension home economics--reaching today's families / prepared by Extension Service.	1984
1689	1429083	A 1.68:1361	31205014944712	Southern pines : better profits for marginal lands / prepared by Extension Service. [et al]	1984

Wipe out serials

Use conditional formatting on the sudoc column to highlight the cell if it contains any punctuation followed by a space.

Sort by color & delete all rows with a highlighted cell.

The image shows a screenshot of the Microsoft Excel ribbon, specifically the 'Conditional Formatting' section. The ribbon includes icons for 'Conditional Formatting' and 'Format as Table'. Below these are several preset styles: 'Normal' (white), 'Bad' (pink), 'Good' (green), 'Neutral' (yellow), 'Calculation' (grey), and 'Check' (dark grey). The 'Conditional Formatting' dropdown menu is open, displaying various rule categories: 'Highlight Cells Rules', 'Top/Bottom Rules', 'Data Bars', 'Color Scales', and 'Icon Sets'. Below these categories are options for 'New Rule...', 'Clear Rules', and 'Manage Rules...'. The 'More Rules...' option at the bottom of the menu is highlighted in green. The background of the spreadsheet shows a grid with some text, including 'Sudoc', 'California groundfish fishery', and 'and California groundfish fishery in ...'.

Sort by random number

Use the random number generation function to create a column of random numbers.

Copy the column and paste as text.

Sort by the newly-created column.

The screenshot shows an Excel spreadsheet with a column of random numbers in column A. A context menu is open over the data, showing options like Cut, Copy, Paste Options, Paste Special..., Insert Copied Cells, Delete, Clear Contents, Format Cells..., Column Width..., Hide, and Unhide. The 'Paste Options' sub-menu is also visible, showing options like Paste, Paste Values, and Paste Options. The 'Paste Values' option is highlighted, indicating the user's intention to paste the data as text.

	A	B	C	D	E
1	Random				Barcode
2	0.184661				312
3	0.159184				312
4	0.868156				312
5	0.861274				312
6	0.297203				312
7	0.536278				312
8	0.705032				312
9	0.845453				312
10	0.338339				312
11	0.343612				312
12	0.810467				312
13	0.05758				312
14	0.655332				312
15	0.812885				312
16	0.035457		2017531	A 1.107:234	312
17	0.675746		2017530	A 1.107:235	312

	A	B	C	D	E	F
1	Random	Sys #	Call #	Barcode	Title	Year
2	2.93E-05	1982692	PE 1.10:T-16	31205020859847	Agroforestry in-service training, Honiara, Solomon Islands, South Pacific, October 23, -October 29,	1984
3	3.35E-05	1354302	EP 1.23:600/3-77-128	31205019257607	The effects of oxidant air pollutants on soybeans, snap beans and potatoes / by H. E. Heggstad, R	1977
4	3.58E-05	1363882	C 3.2:D 71/pt.A-B	31205021425762	Domestic and international transportation of U.S. foreign trade, 1976.	1979
5	3.73E-05	1846964	Y 4.Ag 4:W 58	31205018104453	The 1961 White House Conference on Aging : basic policy statements and recommendations / prepare	1961
6	4.59E-05	2016635	ED 1.2:ST 2/8	31205021464530	Mathematics and Science Achievement State by State, 1998	1998
7	5.25E-05	1413098	C 3.223/11:980/286	31205020383517	1980 census of population and housing. Census tracts. Pittsburgh, Pa., standard metropolitan sta	1983
8	5.59E-05	1975634	EP 1.57/3:N 69/3	31205020487201	Environmental impact statement for the noise emission regulations for motorcycles and motorcycle exha	1980
9	6.59E-05	1472503	PrEx 1.10:Su 7	31205020457899	Special report : an examination of the impact of supported employment on our nation's citizens wit	1989
10	6.67E-05	3371314	D 114.7:SI 2/V.3/2008	31205032246249	The Signal Corps : the outcome (mid-1943 through 1945) / by George Raynor Thompson and Dixie R.	2008
11	7.3E-05	2845553	HE 20.6215:1-/-/979-81	31205032079491	U.S. decennial life tables for 1979-81.	1985
12	7.82E-05	1378687	ED 1.118/2:Aw 1	31205019365988	Request for proposals - multiple awards ; category A : achievement trends and characteristics : ca	1980
13	7.89E-05	1344596	HE 20.6112/2:1	31205021240260	Selected bibliographic references on methodologies for community health status assessment / prepar	1977
14	9.57E-05	1454182	I 1.98:W 15/2/wild.	31205019599172	Wilderness recommendations for the Walker Resource Area : final environmental impact statement /	1987
15	9.89E-05	1456431	HE 20.3182:C 33	31205023321779	Cellular transforming genes.	1988
16	0.000122	1497308	C 3.224/3-8:CH-S-1-23	31205016567487	1990 housing highlights : Massachusetts.	1991
17	0.000124	3320508	I 29.21:J 35/6/2008	31205032207886	Jefferson National Expansion Memorial, Missouri / National Park Service, U.S. Department of the In	2008
18	0.000129	2158349	C 3.215/4:C 40	31205019945136	Construction reports. C40, Housing authorized by building permits and public contracts. Annual	1966
19	0.000141	1464055	Y 4.P 96/10:S.prt.100-144	31205018386605	A Legislative history of the Water Quality Act of 1987 (Public Law 100-4) : including Public Law 9	1988
20	0.000141	1369061	HE 19.202:N 73	31205019947892	An evaluative look at nontraditional postsecondary education / papers prepared / in 1977 by the Cent	1979
21	0.000151	1998706	FR 1.51:155	31205021240310	The funding of private pension plans / Mark J. Warshawsky.	1987
22	0.00016	1425512	C 3.24/8:MC 82-I-37 A-2 (31205020201719	1982 census of manufactures. Preliminary report. Industry series. Truck and bus bodies (indust	1984
23	0.00016	2731850	Y 3.G 79/2:2 R 29	31205032040451	The future of the great plains. Report of the Great plains committee.	1936
24	0.000164	1387517	EP 5.2:C 82	31205020444798	Cost analysis methodology and protocol estimates : OECD minimum pre-market data test protocols /	1981
25	0.000171	1929743	Y 4.St 2/3:K 84/4X	31205019929098	Korean influence investigation : report / by the Committee on Standards of Official Conduct (pur	1978
26	0.000182	2499555	S 9.10:12725	31205026569309	Trade, space launch services : agreement between the United States of America and Ukraine, signed	2003
27	0.000221	1378717	E 1.30:04934-26	31205019800802	Legal obstacles and incentives to the development of small scale hydroelectric power in Ohio / pre	1980
28	0.00023	1877653	S 1.127:ER 4	31205019131133	Eritrea, 1996 post report / United States Department of State.	1996
29	0.000234	2206696	Y 3.W 58/4:2 R 88	31205024544809	Reports of the special concerns sessions : the rural and the poor elderly / 1971 White House Con	1972
30	0.000239	887887	I 1.98:Y 6X	31205027427770	Final environmental statement : proposed plan of development, Santa Ynez unit, Santa Barbara chann	1974
31	0.000255	1711037	PREX 1.10:EM 7/14	31205014350233	President's Committee on Employment of People with Disabilities : vice chairs.	1994
32	0.000274	3555967	AE 2.110:111-307	31205032451690	An Act to Amend Section 42 of Title 18, United States Code, to Prohibit the Importation and Shipment	2010
33	0.000276	1884991	L 37.102:AP 6/4/996	31205019290178	National Apprenticeship Program.	1996
34	0.000297	4545532	D 114.2:V 67/4	31205032504282	Buying time, 1965-1966 / by Frank L. Jones.	2015
35	0.000299	2402655	I 37.2:Y 8/21/TOOL KIT	31205027400298	Youth council toolkit.	2002

Add teams

Cut the list down to a more reasonable size:

$$\{([\text{PARTICIPANTS}/2]) * ([\text{DOCS per DAISY}])\} + \text{EXTRAS}$$

Assign a letter to each pair of PARTICIPANTS. Each pair needs to get enough DOCS for one DAISY.

32	G1	AE 2.110:111-307	An Act to Amend Section 42 of Title 18
33	G2	L 37.102:AP 6/4/996	National Apprenticeship Program.
34	G3	D 114.2:V 67/4	Buying time, 1965-1966 / by Frank L.
35	G4	L 37.2:Y 8/21/TOOLKIT	Youth council toolkit.
36	G5	LC 3.4/2:63/995	Reproductions of copyrighted works f
37	H1	C 3.223/11:1990 CPH-3-296	1990 census of population and housin
38	H2	TD 1.125:80-6	Safety effectiveness evaluation : sele
39	H3	S 9.10:11933	Defense, personnel exchange : memc
40	H4	Y 4.AP 6/1:C 73/2/2015/PT	Commerce, Justice, science, and relat
41	H5	Y 4.F 76/2:S.HRG.112-610	Maritime territorial disputes and sover
42	I1	C 3.186:P-60/63	Average family income up 8 percent in
43	I2	A 13.31:Oa 4/985	Oak / [Ivan L. Sander and Howard N.
44	I3	I 49.89/2:88 (23)	Life history and environmental require
45	I4	C 3.223/11:1990 CPH-3-280	1990 census of population and housin
46	I5	Y 4.G 74/7:110-98	Oil and gas development : exemption
47	J1	C 3.223/6:970/B 54	1970 census of population. General p
48	J2	EP 6.2:R 11/19/v.1-2	Background information document :
49	J3	EP 1.8/3:T 51/974	Development document for effluent li
50	J4	C 55.34:N 42X	New Jersey coastal management prog
51	J5	A 13.88:SRS-50	Proceedings of a conference on sustain
52	EXTRA	EP 1.8/7:340/1-76-004	Compliance status of major air polluti
53	EXTRA	Y 4.AP 6/1:ST 2/4/2017/PT	State, foreign operations, and related
54	EXTRA	GS 4.10:150	Preliminary inventory of the Sir Henry
55	EXTRA	C 61.12:81-18	Marketing in Guatemala / prepared b
56	EXTRA	Y 3.T 22/2:12 D 45	Using desalination technologies for wa
57	EXTRA	I 20.51:Ok 4/968	Indians of Oklahoma.

Tag participating docs

Write each sudoc on its own sticky note.

Keep in mind that some of these sticky notes will go on a doc in the daisy chain, some will be handed out to participants, and some will be the “prize” sticky on the correct document.

You’ll need doubles for the daisy connectors.

Keep track of which sticky goes where.



E 1.2 : B 29

name:

⑤ Stem

⑤ Pub

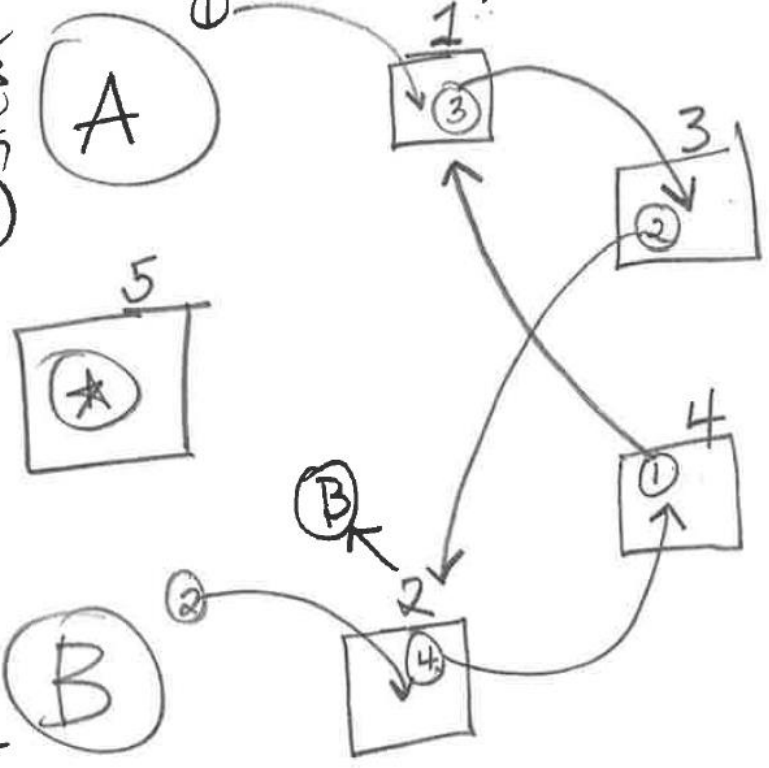

- ① for A ; ① on 4
- ② for B ; ② on 3
- ③ on 1
- ④ on 2
- ⑤ stem for A
- ⑤ pub for B
- * on 5



E 1.2 : B 29

name:

hathitrust.org

S 9.10:



C 3.205/3: WP-983

name:

hathitrust.org

10074

Team	Call #	Title	Year
E3	A 13.27/2:F 51/13	Fire endurance under design load for walls of	1981
B1	A 13.36/2:G 56/996	Go for the gold! : a fall color viewing guide fo	1996
G5	A 13.78:NE-648	Photographic guide of selected external defec	1991
D5	A 57.2:G 79/13	Grazing lands conservation initiative.	1996
F3	G 3.158:MQ-35 W / 960-67	Current industrial reports. MQ-35W, Metals	0
A2	C 3.205/3:WP → 983	World population.	1973
D2	C 3.223/11:960/84	U.S. censuses of population and housing, 196(1961
B4	C 3.223/18:990 CPH-1-23	1990 census of population and housing. Sum	1991
C2	C 56.202:C 73X/5	1970 census of housing. Components of inve	1973
I1	C 56.218:P-25/562	1973 population and 1972 per capita income	1975
I2	C 57.11:78-38	World trade outlook for Eastern Europe, Unio	1978
J3	C 61.2:C 63/8X	Coal in the United States : reserves, producti	1987
A1	E 1.2:B 29	Basalt waste isolation project : operated by F	1980
F1	E 1.2:F 98/2	[The future of energy is in your hands].	1990
D4	ED 1.302:R 88	Improving rural schools / Paul M. Nachtigal.	1980
G4	ED 1.308:ED 8/6/ Su 7	<u>A pocket guide to ERIC.</u>	1982
H5	EP 1.17:822, 825	Multimaterial source separation in Marblehea	1979
B5	EP 1.23/8:600/7-77-101	Energy consumption of environmental contro	1977
H1	EP 1.23/8:600/7-78-083	Evaluation of the U.S. Geological Survey Labor	1978



Miss Adelaide R. Hasse, Librarian, Office of Public Documents, Washington, D. C.



Miss Adelaide R. Hass, Librarian, Office of Public Documents, Washington, D. C.

The Patron Saint of Government Documents Librarians

Organizing materials

Adelaide Hasse's innovation: government publications are most frequently requested and accessed by publishing office.

This organization scheme makes government documents collection browseable for researchers, and comparable for librarians.

Rather than picking a subject, we 'discover' a documents classification.

Reading sudoc call numbers

Stem → EP 1.23/9:600/8-84-O 29 Publication

Everything before the colon describes the issuing body.

Everything after the colon describes the specific publication.

Interpreting sudoc call numbers

Most initial letters correspond to agencies:

A → Department of Agriculture (USDA)

E → Department of Energy

ED → Department of Education

EP → Environmental Protection Agency

Interpreting X & Y

Not chromosomes, but Congress

X → journals, including the Congressional Record

Y → Congressional publications, including hearings (Y 4s)

Three rules for finding sudoc call numbers

1. Every number is a whole number.

decimal order	sudoc order
D 1.1:	D 1.1:
D 1.12:	D 1.3:
D 1.122:	D 1.12:
D 1.3:	D 1.33:
D 1.33:	D 1.122:

Three rules for finding sudoc call numbers

2. Years, Letters, Numbers.

A 1.35/993	EP 1.23/998
A 1.35/R 42	EP 1.23/A 62
A 1.35/R 42/995	EP 1.23/91-44
A 1.35/R 42/2	EP 1.23/600/998-103
A 1.35/321	EP 1.23/600/R-98-23

Three rules for finding sudoc call numbers

2. Years, Letters, Numbers

A 1.35: 993	EP 1.23: 998
A 1.35: R 42	EP 1.23: A 62
A 1.35: R 42/ 995	EP 1.23: 91-44
A 1.35: R 42/ 2	EP 1.23: 600/ 998-103
A 1.35: 321	EP 1.23: 600/ R-98-23

Three rules for finding sudoc call numbers

3. Nothing comes before something.

C 3.186:	EP 1.23:
C 3.186/2:	EP 1.23/A:
C 3.186/7:	EP 1.23/A-2:
C 3.186/7-3:	EP 1.23/2:
C 3.186/9:	EP 1.23/2-2:



MSU LIBRARIES | Government Documents

[Resources](#)
[Research Guides](#)
[Data Services](#)
[About Us](#)
[News](#)

SuDocs Basics

The SuDocs (Superintendent of Documents) system is straightforward on the surface--A call numbers are publications of the Department of Agriculture, C is Commerce, D is Defense, and so on. This type of system is called a provenance system--it organizes publications based upon issuing agency.

There are exceptions to the straightforward letters, of course: Y 1 call numbers are general publications of Congress--House and Senate Documents and Reports, Y 3 call numbers are independent boards and commissions, and Y 4 call numbers are House and Senate Committee hearings and publications.

This tutorial is not intended to explain the classification system in great detail. It's doubtful that you need to know that much about the system, but just want to be able to find, shelve or file items which are in SuDocs call number order. If you do want to understand more about the construction of the call number and what the numbers mean, there are several places on the Federal Depository Library Program web site where you can learn much more.

- [Detailed Explanation of the SuDocs System](#)
- [Extremely Detailed Explanation](#)

Focus on the Three Things You *Really* Need to Know

1. It is not a decimal system. The number after the point is a whole number

Decimal vs. SuDocs Order	
Decimal Order	SuDocs Order
D 1.1:	D 1.1:
D 1.12:	D 1.3:
D 1.122:	D 1.12:
D 1.3:	D 1.33:
D 1.33:	D 1.122:

2. If the call number is the same to a certain point, then varies, the order is: Years, Letters, Numbers. Until the year 2000, the first number was dropped from years, so those years have 3 digits. Beginning with the year 2000, years will be 4 digits.

Years/Letters/Numbers Order	
Example 1	Example 2
A 1.35:993	EP 1.23:998
1.35:993	EP 1.23:998



What worked?

- Framing session as hands-on experience
- Plan exercise based on finding, not shelving
- Enthusiasm! (my usual toolkit)

What didn't work?

- Amount of time needed to prepare
- Problem-solving during exercise
- Minimal reinforcement for learned skills

What's next?

- I'm not sure!



thank you!